

Carbon Film Leadless Fixed Resistors

Performance Specification

| | |
|-------------------------|---|
| Temperature Coefficient | 1R ~ 100K : ± 350PPM/°C 101K ~ 500K : ± 700PPM/°C 501K ~ 1M : ± 1000PPM/°C 1M ~ 5.1 : ± 1500PPM/°C |
| Short Time Overload | ±(0.5% + 0.005Ω)Max, with no evidence of mechanical damage. |
| Resistance to Soldering | ±(1.0% + 0.05Ω)Max, with no evidence of mechanical damage. |
| Pulse Overload | ±(1.0% + 0.05Ω)Max, with no evidence of mechanical damage. |
| Load Life | ±(2.0% + 0.05Ω)Max, with no evidence of mechanical damage. |
| Load Life in Humidity | ±(5.0% + 0.05Ω)Max, with no evidence of mechanical damage. |
| Solderability | 95% Coverage Min. |

Ordering Procedure: Ex.: MELF Carbon Film type 0204 1/4W-S +/-5% 75Ω Tape/Reel 3000

M C 2 4 S 4 J 0 7 5 0 T 3 0

Type:

MC24 = Carbon Film 0204
MC27 = Carbon Film 0207
MC39 = Carbon Film 0309

Wattage:

Small size:
S4 = 1/4W-S
S2 = 1/2W-S
1S = 1W-S
Extra Small size:
1U = 1W-SS
2U = 1W-SS

Resistance Value:

E-24 series:
1st digit is "0"
2nd & 3rd digits are significant figures of the resistance
4th indicates the number of zeros
"J" ~ 0.1, "K" ~ 0.01
Ex. 4.7Ω ~ 47J, 4.7KΩ ~ 472

Packing Type:
T = Tape/Reel

Packing Qty:
2 = 2,000 pcs.
3 = 3,000 pcs.
B = 2,500 pcs.

Additional Information:
0 = NIL

Features

- SMD carbon resistor
- High tenninal strength
- Excellent solderability
- Suitable for Flow, Reflow and hand soldering

Derating Curve

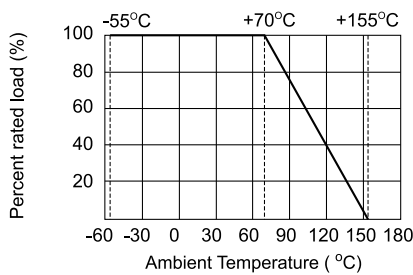

Tolerance:
G = ±2%
J = ±5%

1st color band

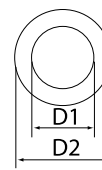
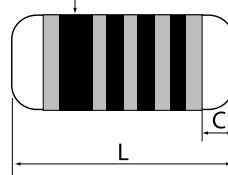

| Part No. | Power Rating at 70 °C | Dimension (mm) | | | | Resistance Range | Max Working Voltage | Max Overload Voltage | Std Packing (Reel) |
|----------|-----------------------|----------------|----------|-------|---------|------------------|---------------------|----------------------|--------------------|
| | | D1 | D2 (Max) | L±0.2 | C (Min) | | | | |
| MC24S4 | 1/4W (0.25W) | 1.4±0.15 | 1.55 | 3.5 | 0.5 | 1Ω ~ 5.1MΩ | 200V | 400V | 3,000 |
| MC27S2 | 1/2W (0.50W) | 2.2±0.2 | 2.4 | 5.9 | 0.5 | 1Ω ~ 5.1MΩ | 300V | 600V | 2,000 |
| MC271U | 1W | 2.2±0.1 | 2.4 | 5.9 | 0.5 | 1Ω ~ 5.1MΩ | 350V | 700V | 2,000 |
| MC391S | 1W | 3.2±0.2 | 3.4 | 8.5 | 0.5 | 1Ω ~ 5.1MΩ | 350V | 700V | 2,500 |
| MC392U | 2W | 3.2±0.2 | 3.4 | 8.5 | 0.5 | 1Ω ~ 5.1MΩ | 350V | 700V | 2,500 |